

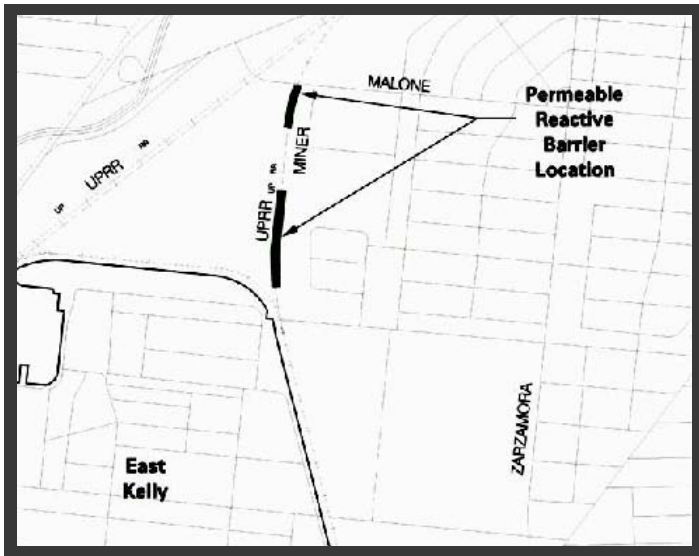

January 2004

## Community Bulletin

# PRB Installation south of Malone Street



*The site of the two PRBs.*

The Air Force will be installing one permeable reactive barrier (PRB) in two sections south of Malone Street early this year. The Air Force has requested permission to install the PRB on Union Pacific Railroad (UPRR) property. The project should be done this May.

This PRB will be a flow-through barrier that uses iron filings to treat contaminated groundwater. The iron filings will be injected underground.

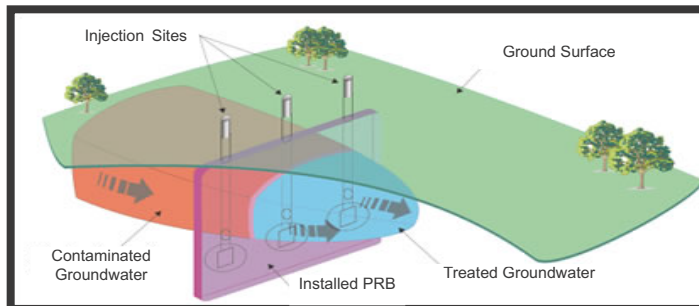

*Courtesy of Geosierra LLC.*

*Conceptual Model of the PRB Injection Technique.*

### Have Questions About the Environmental Cleanup Program at Kelly?

We've Got Answers!

The AFRPA is dedicated to involving the community in the cleanup of the former Kelly AFB. If you have any questions, please call the AFRPA Information Line at (210) 925-0956, visit the Kelly Web site at <http://www.afropa.hq.af.mil/kelly/>, or drop us a line at our new address:  
143 Billy Mitchell Blvd., Suite 1  
San Antonio, Texas 78226-1816

Perchloroethylene (PCE) and trichloroethylene (TCE) are solvents that were used at Kelly for aircraft maintenance. The goal of the PRB is to bring the levels of the solvents and their breakdown products, 1,2-dichloroethene (DCE) and vinyl chloride (VC) in the shallow groundwater to drinking water standards. When the water and solvents come into contact with the iron, they start to break down into carbon dioxide, ethene, and the mineral chloride, which occur commonly in the groundwater near Kelly.

The shallow groundwater is not a drinking water source and it is separated from the Edwards Aquifer by more than 1,000 feet of rock and clay.

If UPRR grants approval, the PRB will be installed in two sections. One section will be about 500 feet long and about 45 feet deep. It will be located along the railroad tracks about 15 feet south of Malone Street. Section two will be about 1,000 feet long and 45 feet deep. It will be located along the railroad tracks just north of East Kelly. Once the PRB has been installed, it will not be visible.

The Air Force will also be working with San Antonio Metropolitan Health District's (SAMHD) Public Center for Environmental Health (PCEH) to conduct air monitoring in accordance with state and federal environmental regulations.